

CHADSWORTH PHASE 1 CITY OF BRISTOL 2nd CIVIL DISTRICT SULLIVAN COUNTY, TENNESSEE OCTOBER 6, 2008

CURVE DATA		
NUMBER	CHORD	DELTA
C1	S 29'01.35" E 36.18	08°14'02"
C2	S 11°44'18" E 289.04	72°17'45"
C3	S 67°29'41" E 118.86	40°05'00"
C4	N 32°02'26" E 58.56	11°47'39"
C5	S 88°59'43" E 410.48	82°08'03"
C6	S 18°29'31" E 34.36	66°48'11"
C7	S 24°19'23" E 5.53	01°10'21"
C8	S 17°54'25" W 54.85	11°39'36"
C9	S 08°18'30" W 54.28	11°32'14"
C10	S 08°13'47" E 54.28	11°32'20"
C11	S 18°48'09" E 54.29	11°32'24"
C12	S 28°18'35" E 54.29	11°32'27"
C13	S 39°51'02" E 54.29	11°32'28"
C14	S 46°30'14" E 8.39	01°48'35"
C15	S 50°17'59" E 19.83	05°46'55"
C16	S 61°54'34" E 59.20	17°24'59"
C17	S 78°22'28" E 82.78	23°02'16"
C18	S 85°18'03" E 35.40	07°20'16"
C19	S 92°24'45" E 28.21	48°40'47"
C20	S 27°37'05" W 13.62	14°26'25"
C21	S 85°16'57" E 97.47	25°21'33"
C22	S 73°33'16" W 60.83	42°59'27"
C23	S 27°00'01" E 53.29	37°27'09"
C24	S 42°36'08" W 21.19	4°40'13"
C25	S 47°35'42" W 35.32	89°52'15"
C26	N 17°07'57" E 52.22	20°40'28"
C27	N 57°05'27" W 49.05	19°24'32"
C28	N 31°15'54" W 122.18	32°14'33"
C29	N 00°01'24" W 114.77	30°14'28"
C30	N 28°01'35" E 15.84	05°14'02"
C31	N 35°02'26" E 53.43	11°47'38"
C32	N 80°42'36" E 141.34	31°32'41"
C33	S 47°46'17" E 141.12	31°29'34"
C34	S 57°28'36" E 130.62	29°05'48"
C35	N 60°04'07" W 54.68	33°13'01"
C36	S 89°01'29" W 47.82	28°35'48"
C37	N 35°18'06" E 42.88	05°02'31"
C38	N 28°37'51" E 35.01	03°16'02"
C39	N 15°35'30" E 181.98	17°28'57"
C40	N 05°15'19" E 50.03	50°55'43"
C41	S 47°26'58" W 37.87	07°00'16"
C42	N 57°10'59" W 78.25	14°30'03"
C43	N 72°06'30" W 82.80	15°20'57"
C44	S 72°34'36" W 48.15	09°02'39"
C45	S 40°23'26" W 32.89	87°18'47"
C46	S 76°56'30" W 47.11	50°42'42"
C47	S 32°08'12" E 38.40	36°35'54"
C48	N 70°33'55" E 38.40	36°38'59"
C49	N 31°54'55" E 28.40	36°38'59"
C50	N 39°55'45" W 13.58	14°10'54"
C51	N 22°10'48" W 28.21	48°40'47"
C52	N 47°35'42" E 35.32	89°52'15"
C53	N 42°24'16" W 35.40	80°07'45"

LINE TABLE		
NUMBER	DIRECTION	DISTANCE
L1	N 56°32'25" E	11.41'
L2	N 25°59'06" W	30.75'
L3	N 25°59'06" W	13.04'
L4	N 54°35'54" E	5.55'
L5	S 87°16'05" E	9.00'

CERTIFICATION OF COMMON AREAS DEDICATION

I HEREBY CERTIFY THAT I HAVE AND THE UNDERSIGNED HAS REVIEWED THIS PLAN, CERTAIN AREAS OF LAND ARE DESIGNATED AS COMMON AREAS FOR RECREATION AND OR OTHER RECREATIONAL ACTIVITIES. THE ABOVE-DENOTED AREAS ARE NOT TO BE USED FOR ANY OTHER PURPOSES, AND ALL RIGHTS OR INTERESTS IN SUCH AREAS ARE HEREBY DEEDED TO THE COMMON USE OF THE FUTURE OWNERS OF THE SUBDIVISION. THIS DEDICATION IS SUBJECT TO THE APPROVED AND ADEQUATELY MAINTAINED AND OPERATED BY THE COMMON OWNERS OF THE SUBDIVISION.

10-7-08 *T. Morrell*
T. Morrell
REGISTERED SURVEYOR LICENSE #1815

CERTIFICATE OF ACCURACY

I HEREBY CERTIFY THAT THE PLAN SHOWN AND DESCRIBED HEREON IS A TRUE AND CORRECT COPY OF THE ORIGINAL SURVEY RECORDS, AND THAT THE SAME WILL BE PLACED IN THE PUBLIC RECORDS OF THE COUNTY RECORDS OFFICE IN BRISTOL, TENNESSEE. I HAVE REVIEWED THE SURVEY RECORDS AND THE PLAN AND FIND THEM TO BE IN ACCORDANCE WITH THE REQUIREMENTS OF THE SURVEYING LAWS AND REGULATIONS.

10/06/08
T. Morrell
REGISTERED SURVEYOR LICENSE #1815

CERTIFICATE OF APPROVAL OF STREETS

I HEREBY CERTIFY THAT THE EXTENSION OF THE STREETS SHOWN ON THIS SUBDIVISION PLAN IS IN ACCORDANCE WITH THE REQUIREMENTS OF THE SULLIVAN COUNTY PLANNING COMMISSION AND THE CITY OF BRISTOL. I HAVE REVIEWED THE PLAN AND FIND IT TO BE IN ACCORDANCE WITH THE REQUIREMENTS OF THE SULLIVAN COUNTY PLANNING COMMISSION AND THE CITY OF BRISTOL.

10/06/08
T. Morrell
REGISTERED SURVEYOR LICENSE #1815

CERTIFICATE OF APPROVAL OF UTILITY SYSTEMS

I HEREBY CERTIFY THAT THE UTILITY SYSTEMS SHOWN ON THIS SUBDIVISION PLAN ARE IN ACCORDANCE WITH THE REQUIREMENTS OF THE SULLIVAN COUNTY PLANNING COMMISSION AND THE CITY OF BRISTOL. I HAVE REVIEWED THE PLAN AND FIND IT TO BE IN ACCORDANCE WITH THE REQUIREMENTS OF THE SULLIVAN COUNTY PLANNING COMMISSION AND THE CITY OF BRISTOL.

10/06/08
T. Morrell
REGISTERED SURVEYOR LICENSE #1815

CERTIFICATE FOR APPROVAL FOR RECORDING

I HEREBY CERTIFY THAT THE SUBDIVISION PLAN SHOWN HEREON HAS BEEN FOUND TO COMPLY WITH THE REQUIREMENTS OF THE SULLIVAN COUNTY PLANNING COMMISSION AND THE CITY OF BRISTOL. I HAVE REVIEWED THE PLAN AND FIND IT TO BE IN ACCORDANCE WITH THE REQUIREMENTS OF THE SULLIVAN COUNTY PLANNING COMMISSION AND THE CITY OF BRISTOL.

10/06/08
T. Morrell
REGISTERED SURVEYOR LICENSE #1815

CERTIFICATE OF OWNERSHIP AND DEDICATION

I HEREBY CERTIFY THAT I HAVE AND THE UNDERSIGNED HAS REVIEWED THIS PLAN, CERTAIN AREAS OF LAND ARE DESIGNATED AS COMMON AREAS FOR RECREATION AND OR OTHER RECREATIONAL ACTIVITIES. THE ABOVE-DENOTED AREAS ARE NOT TO BE USED FOR ANY OTHER PURPOSES, AND ALL RIGHTS OR INTERESTS IN SUCH AREAS ARE HEREBY DEEDED TO THE COMMON USE OF THE FUTURE OWNERS OF THE SUBDIVISION. THIS DEDICATION IS SUBJECT TO THE APPROVED AND ADEQUATELY MAINTAINED AND OPERATED BY THE COMMON OWNERS OF THE SUBDIVISION.

10-7-08 *T. Morrell*
T. Morrell
REGISTERED SURVEYOR LICENSE #1815

CERTIFICATE OF APPROVAL OF RECORDING

I HEREBY CERTIFY THAT THE SUBDIVISION PLAN SHOWN HEREON HAS BEEN FOUND TO COMPLY WITH THE REQUIREMENTS OF THE SULLIVAN COUNTY PLANNING COMMISSION AND THE CITY OF BRISTOL. I HAVE REVIEWED THE PLAN AND FIND IT TO BE IN ACCORDANCE WITH THE REQUIREMENTS OF THE SULLIVAN COUNTY PLANNING COMMISSION AND THE CITY OF BRISTOL.

10/06/08
T. Morrell
REGISTERED SURVEYOR LICENSE #1815

CERTIFICATE FOR APPROVAL FOR RECORDING

I HEREBY CERTIFY THAT THE SUBDIVISION PLAN SHOWN HEREON HAS BEEN FOUND TO COMPLY WITH THE REQUIREMENTS OF THE SULLIVAN COUNTY PLANNING COMMISSION AND THE CITY OF BRISTOL. I HAVE REVIEWED THE PLAN AND FIND IT TO BE IN ACCORDANCE WITH THE REQUIREMENTS OF THE SULLIVAN COUNTY PLANNING COMMISSION AND THE CITY OF BRISTOL.

10/06/08
T. Morrell
REGISTERED SURVEYOR LICENSE #1815

CHADSWORTH PHASE 1

BRISTOL REGIONAL PLANNING COMMISSION

TOTAL ACRES 15.030 TOTAL LOTS 47

ACRES NEW ROAD 3.453 MILES NEW ROAD 0.917

OWNER MORRELL DEVELOPING, LLC CIVIL DISTRICT 2ND

SURVEYOR TODD C. JOHNSON CLOSURE ERROR 1.48.000

SCALE 1" = 80'

SHEET 1 OF 3



TODD C. JOHNSON
TENN. REG. NO. 2155
101 FOUNTAIN PLACE, SUITE 3B
JOHNSON CITY, TN 37602
PHONE: (423) 829-8833
FAX: (423) 829-8833

I HEREBY CERTIFY THAT THIS IS A CATEGORY 1 SURVEY, AND THAT THE RATIO OF PRECISION OF THE UNADJUSTED SURVEY IS 1:49,000 AS SHOWN HEREON.

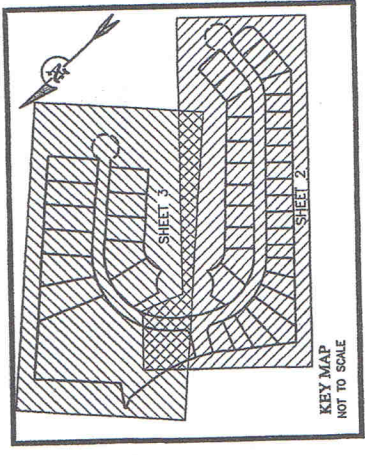

KEY MAP
NOT TO SCALE

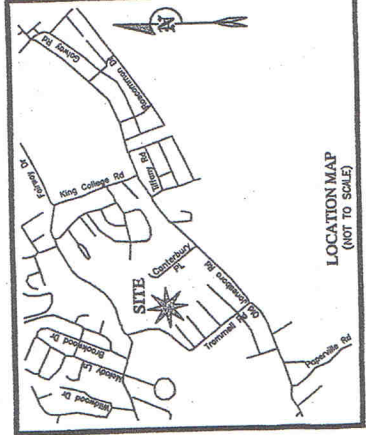

LOCATION MAP
(NOT TO SCALE)

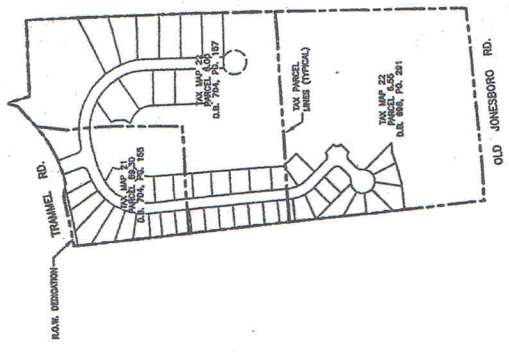

TAX PARCEL MAP
1" = 400'

